

2026 Budget and 2026-2030 Five-Year Capital Plan Overview

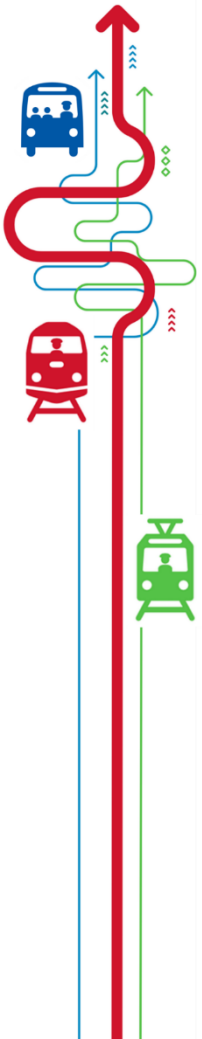

2026 Budget Prioritization Approach



- Funding UTA's base budget and existing service
- Funding critical expenses related to safety, compliance, and risk management
- Capital investments to support UTA's service and maintain UTA's service in a state of good repair
- Meeting UTA's debt service obligations

2026 Projected Operating Revenue: \$685.4M

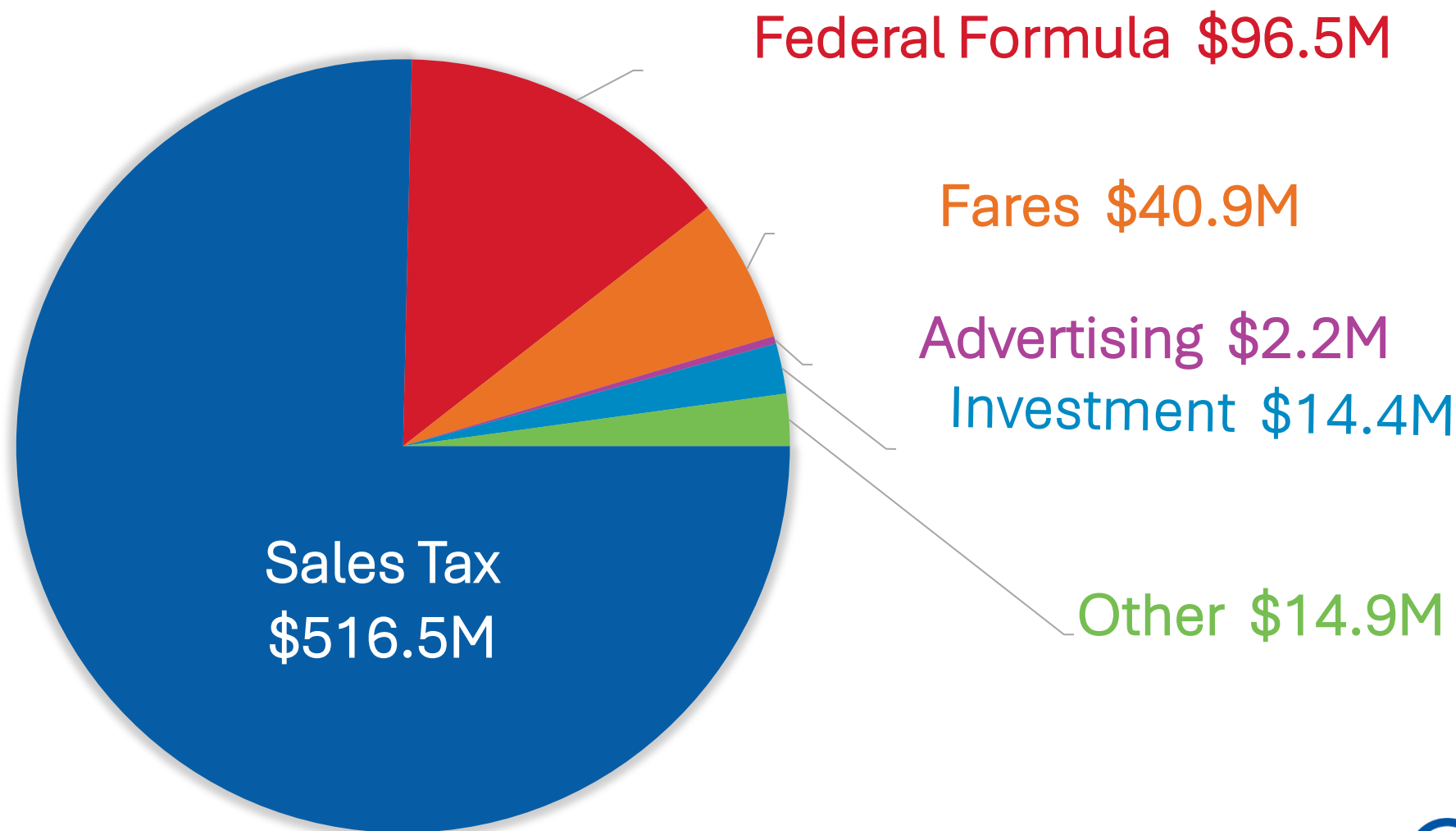
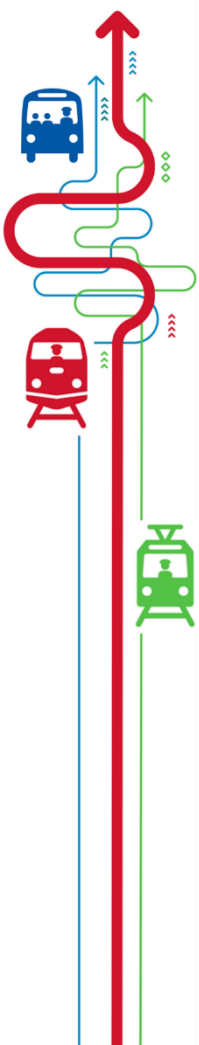

Capital Budget

2026–2030 Five-Year Capital Plan

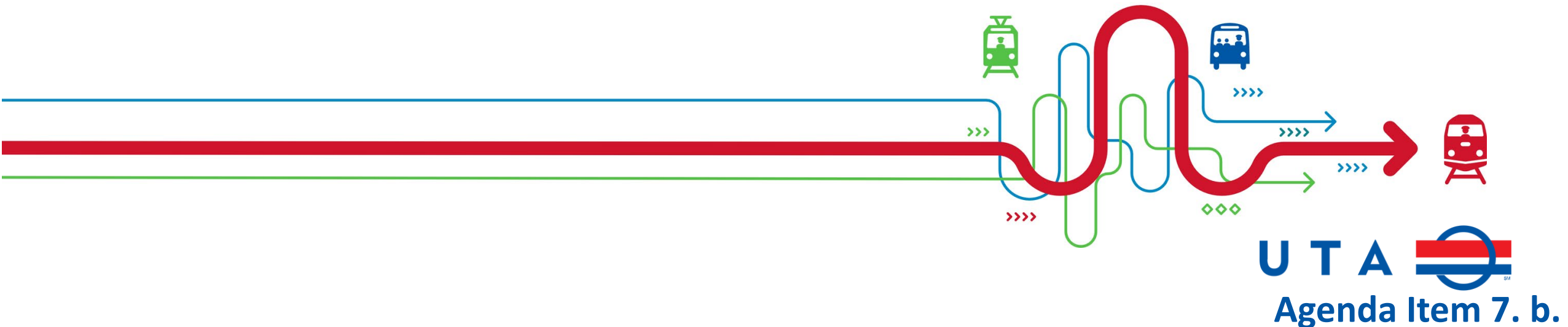

Overview of Plan Development

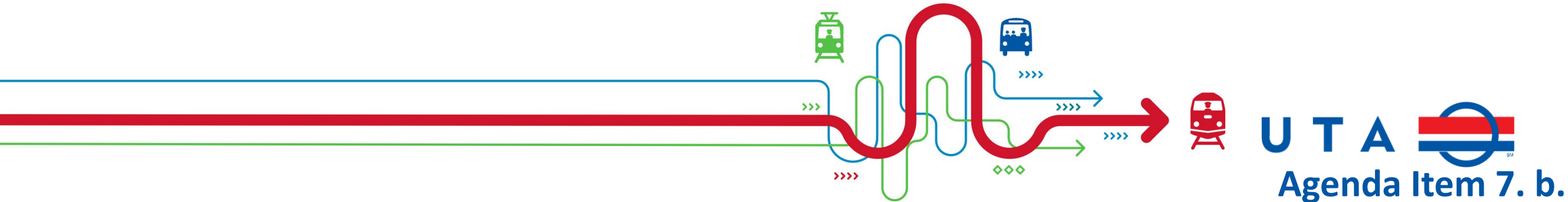

Major Projects - \$578.M

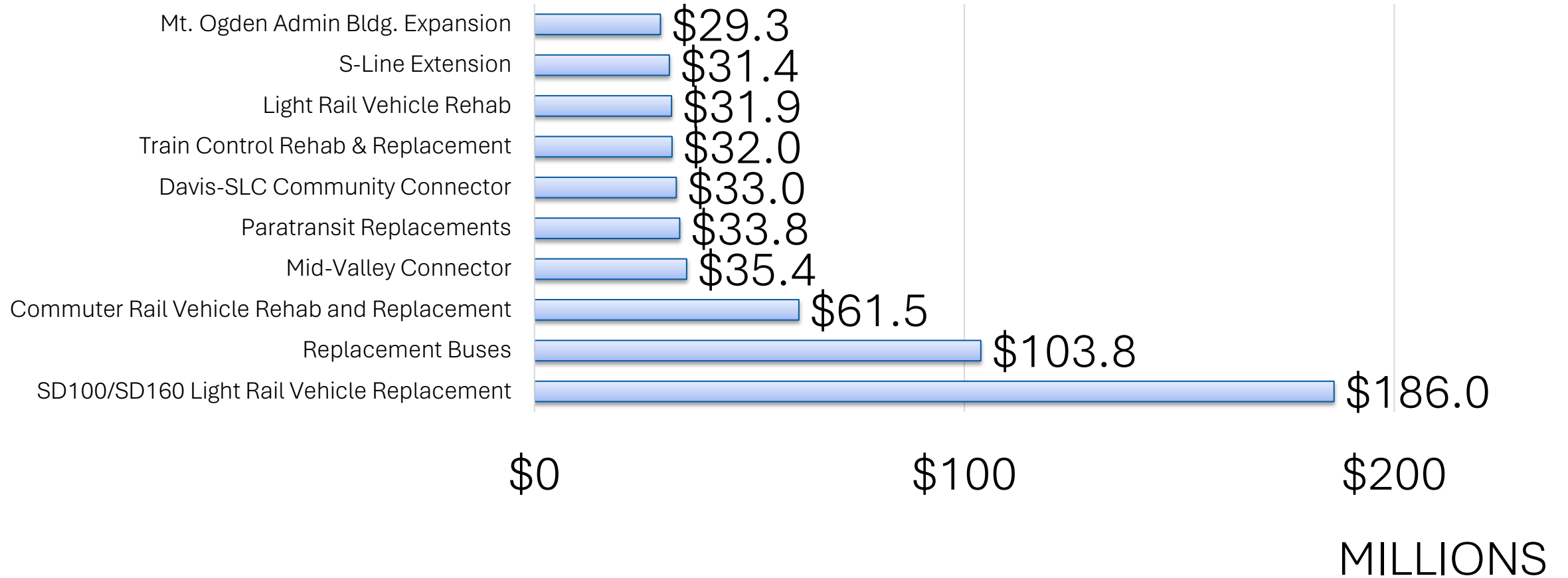

Funding Sources

Year	Bond	Grants	Lease	Local Partner	State	TTIF	UTA Local	Grand Total
2026	\$47,285,000	\$111,148,000	\$49,964,000	\$13,478,000	\$10,622,000	\$42,627,000	\$70,562,000	\$345,686,000
2027	24,915,000	78,135,000	45,520,000	9,300,000	3,856,000	16,153,000	56,082,000	233,961,000
2028	52,117,000	71,275,000	28,028,000	3,033,000	3,093,000	2,852,000	48,534,000	208,932,000
2029	40,697,000	44,456,000	29,640,000	1,521,000	3,393,000	974,000	46,825,000	167,506,000
2030	4,690,000	30,911,000	26,361,000	21,000	700,000	2,151,000	39,420,000	104,254,000
Total	\$169,704,000	\$335,925,000	\$179,513,000	\$27,353,000	\$21,664,000	\$64,757,000	\$261,423,000	\$1,060,339,000

State of Good Repair for 2026

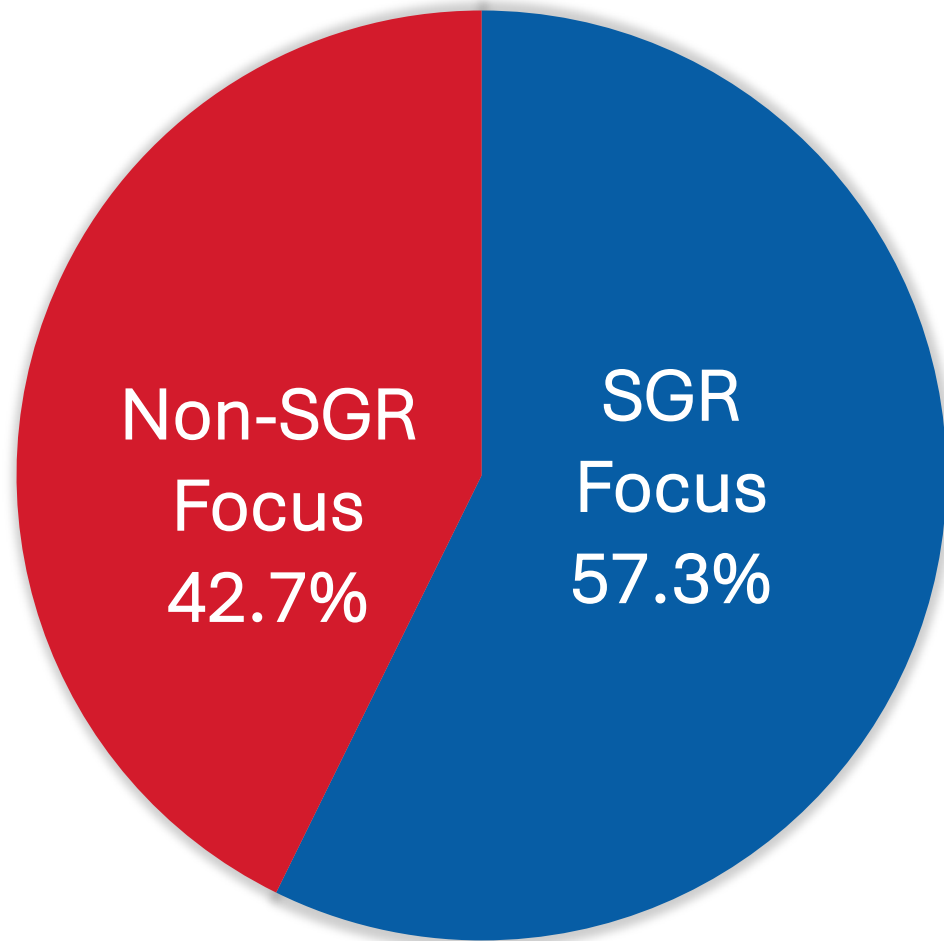

- Total 2026 Budget Proposal- \$345.7M
 - Non-SGR Focus \$147.7M
 - SGR Focus- \$198.0M
- Total SGR Focus Percentage- 57%
 - Lower than the global 74% of Five-Year Plan
 - Still have some large service enhancement projects going into 2026
 - Largest two both have budgets >\$30M
 - Midvalley
 - S-Line

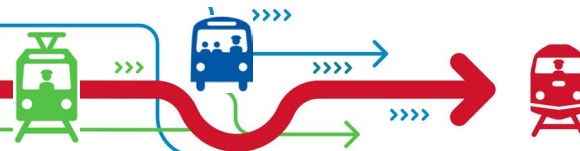

Highlighted Capital Projects

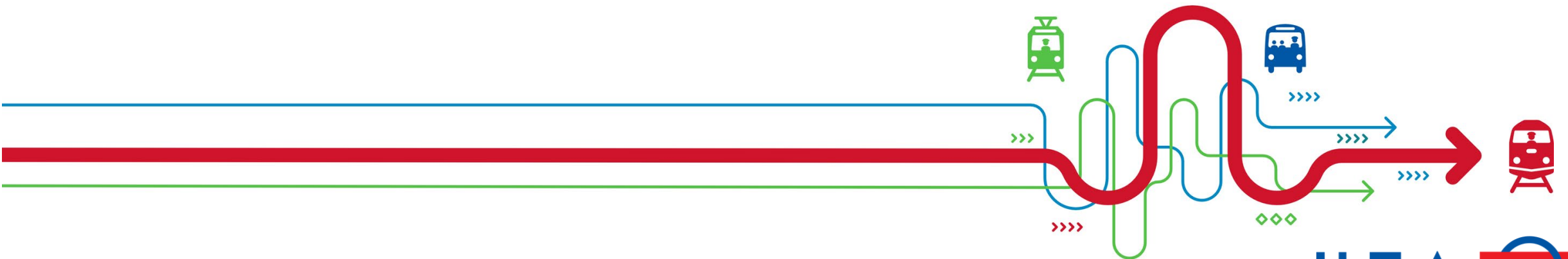

MSP258 – Mt. Ogden Admin Building Expansion: \$29.3M

- 100% design completion late 2025
- Construction 2026 for bus canopy
- Construction of admin building 2027-2028
- 13,000 sq. ft. building
- Preserves UTA property to the west of new building and bus parking

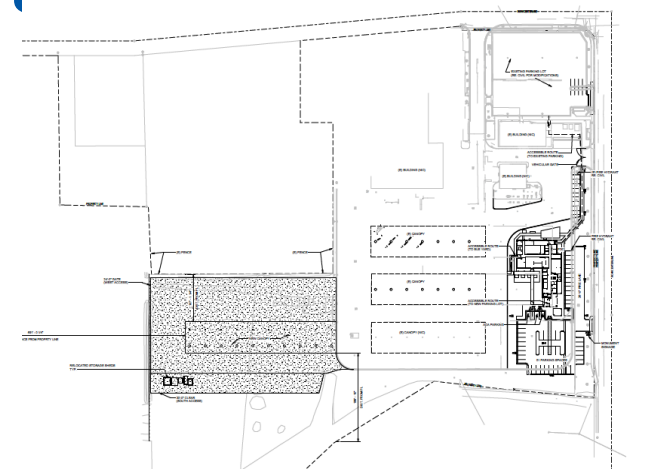

MSP202 – Davis-SLC Community Connector: \$33.0M

- 26.5-mile corridor-based bus rapid transit Farmington to University of Utah Research Park
- Total stations/platforms
 - 39 stations
 - 76 platforms
- CIG-funded stations/platforms
 - 20 stations
 - 37 platforms

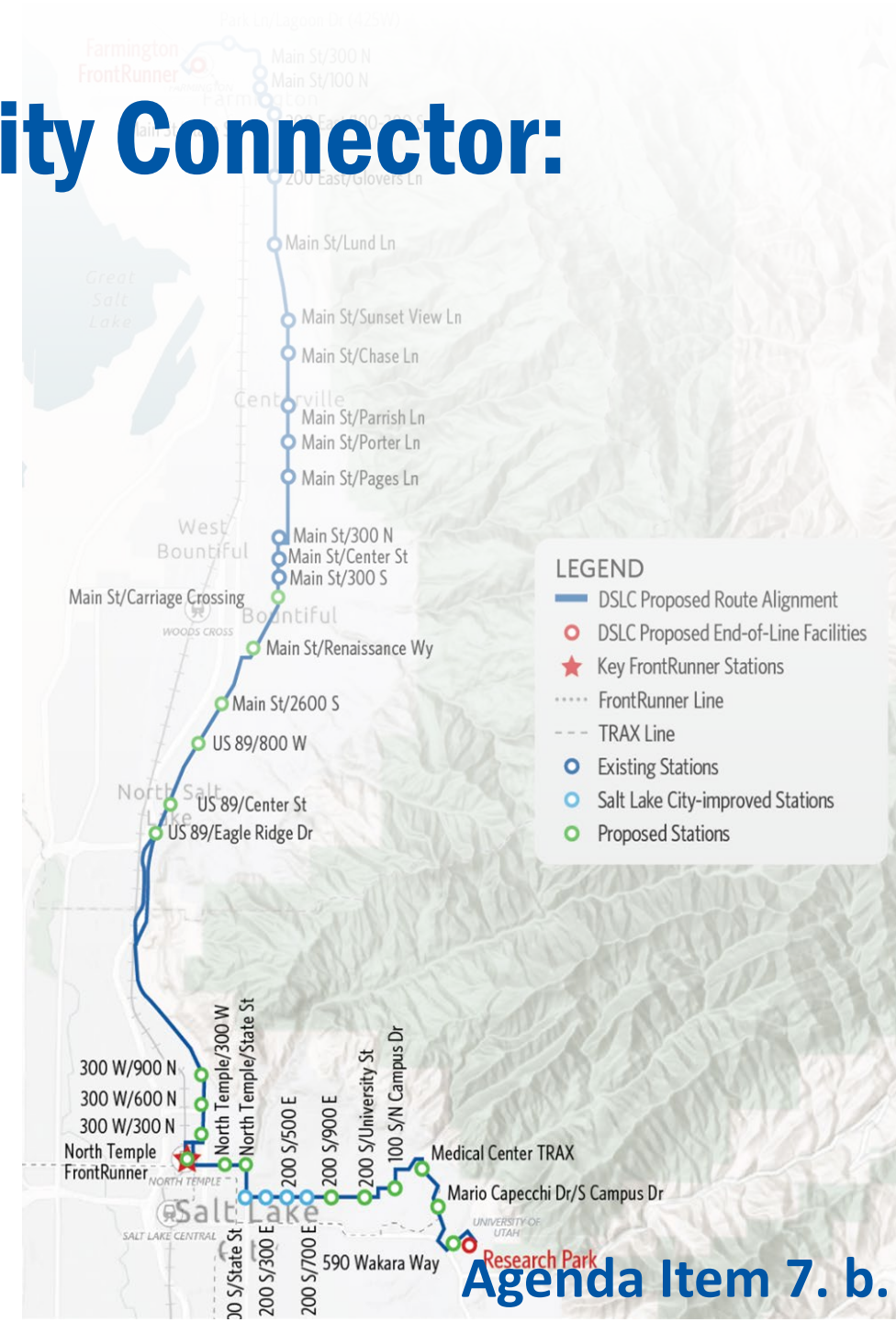

MSP253 — Midvalley Express (MVX): \$35.4M

- Construction 81% complete
- 4700 South sidewalk, wall, and paving complete
- All stations out of the ground waiting for final finishings
- SLCC local routes opening August 2025 Change Day
- WVC working on adapting existing bays
- Murray City waiting for power for restrooms

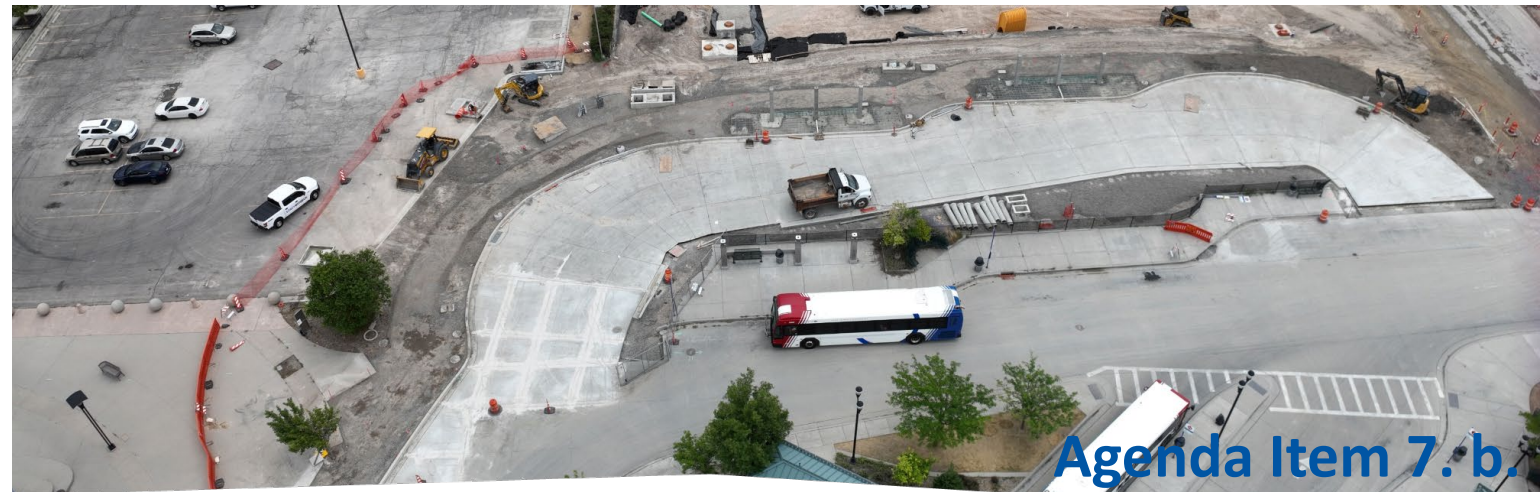

REV238 – SD100/SD160 Light Rail Vehicle

Replacement: \$189.6M

- 40 Siemens SD160/SD100 high-floor boarding LRVs replaced
- Procurement for 40 new Stadler CITYLINK low-floor LRVs
- **First on site:** 3rd quarter 2027
- **Fleet in service:** 3rd quarter 2029
- **Major milestone payments:**
 - 2026: \$65,506,000
 - 2027: \$40,186,000
 - 2028: \$22,907,000
 - 2029: \$41,108,000
 - 2030: \$6,218,000



MSP259 – S-Line Extension: \$31.37M

- Currently at 60% design for terminus east of Highland Drive
- Long-lead material procurement late 2025 for 2026 delivery
- Construction 2026-2027
- City, UDOT, and Developer coordination is key to successfully progressing this project

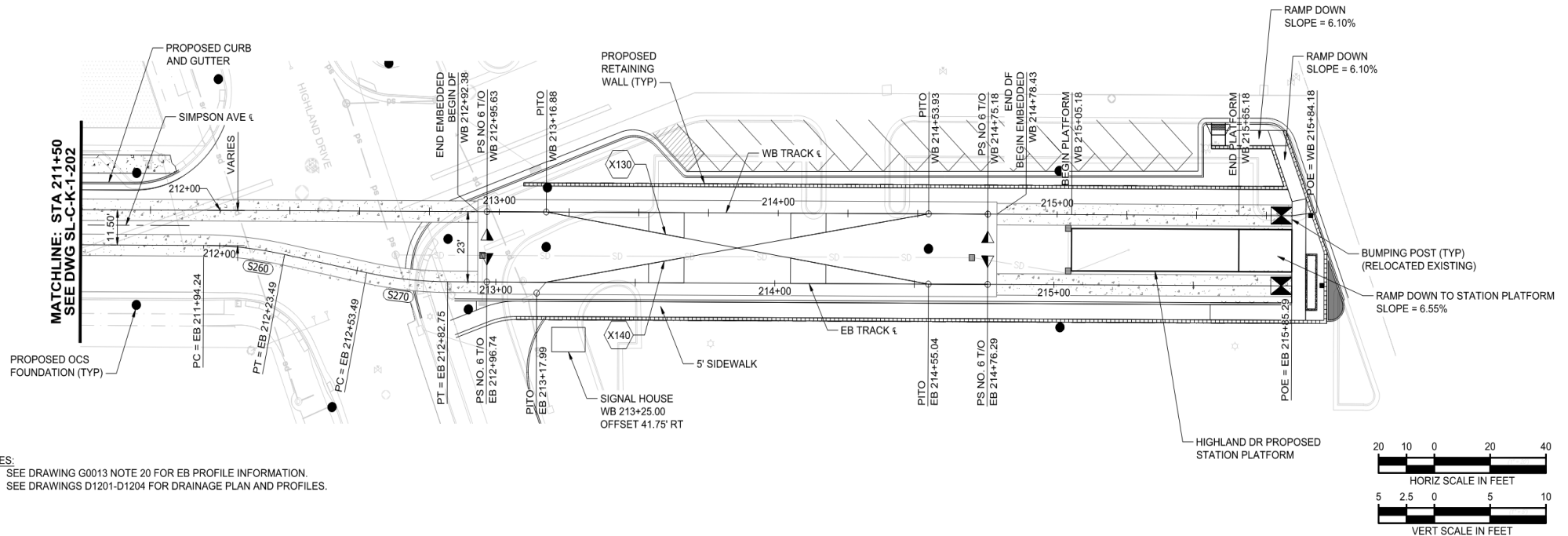

Initial Plan to Current Version

- Updated 2025 plan, for adjustment into 2026
- Worked through additional requests for capital funding
- Conducted risk analysis on projects to identify priority items
- Initial version Total - \$1,251,663,000
- August 8, 2025 Version Total - \$1,062,214,000



Next Steps

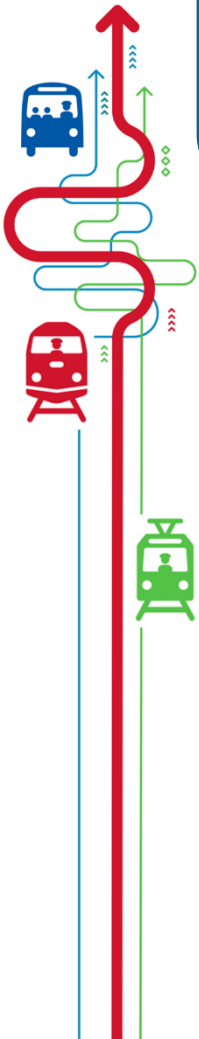

Feedback Incorporation

- Feedback from Board
- Feedback from LAC
- Feedback from Internal Stakeholders

Risk Tolerance

- Measure against Safety, Compliance, Asset Failures, System Performance, Reputational, and Financial Risks

Tentative Proposal

- Proposed Tentative Budget and Plan



Questions?